

ELEVATION

Please note:
Due to the design of Decrabond/Corona type roofing materials it is important that the roof battens are rebated 25 mm around the perimeter of the VELUX Skylight, for the EDW flashing, to maintain aesthetics.

BASIS OF DESIGN:
VELUX Venting
Skylight (VS, VSE)

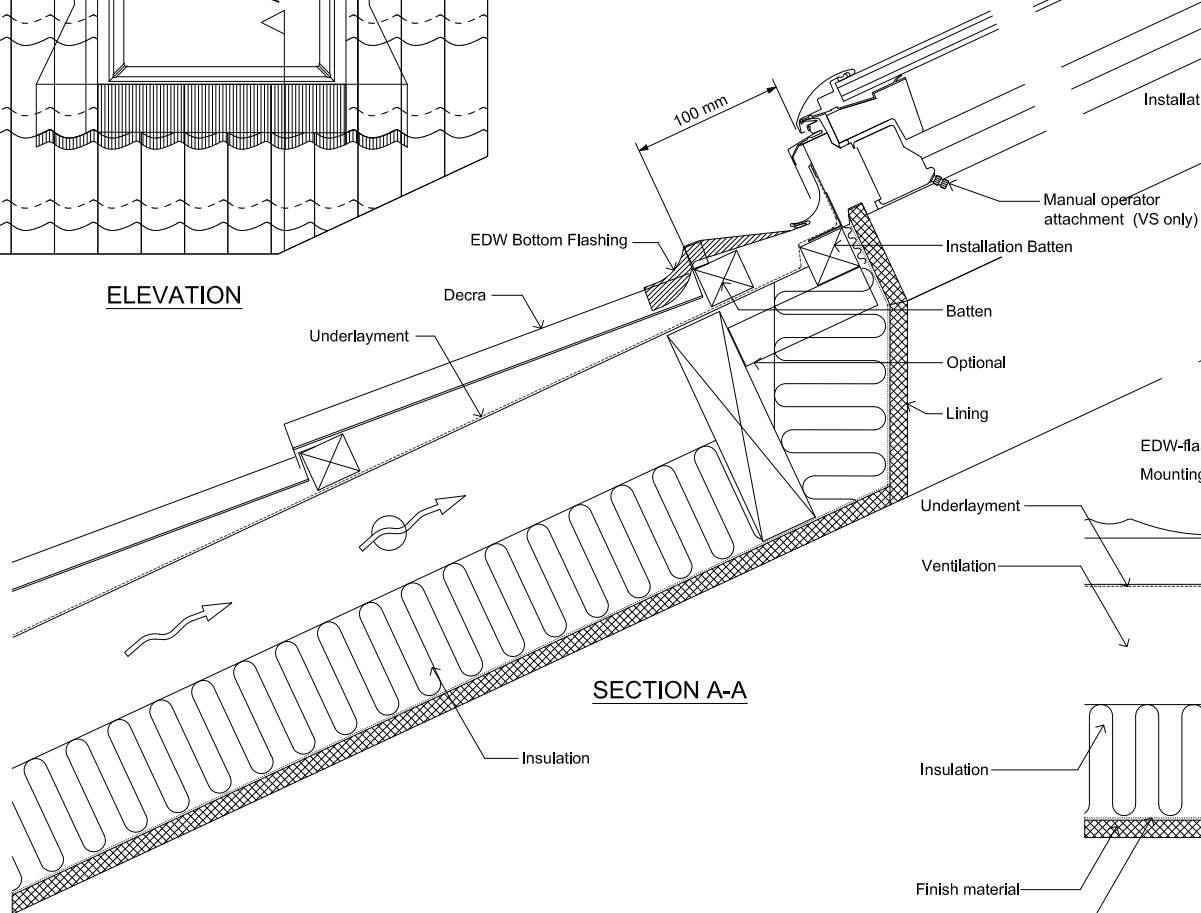

SECTION A-A

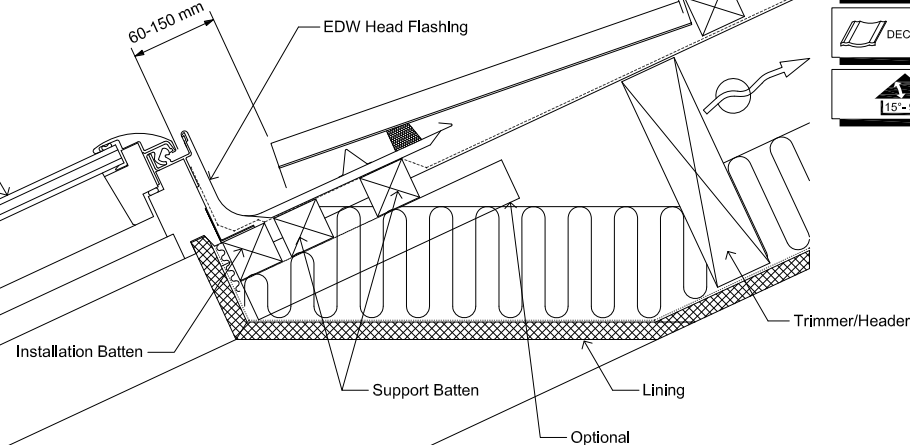

SECTION B-B

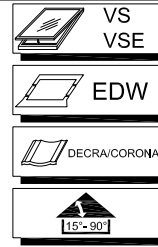
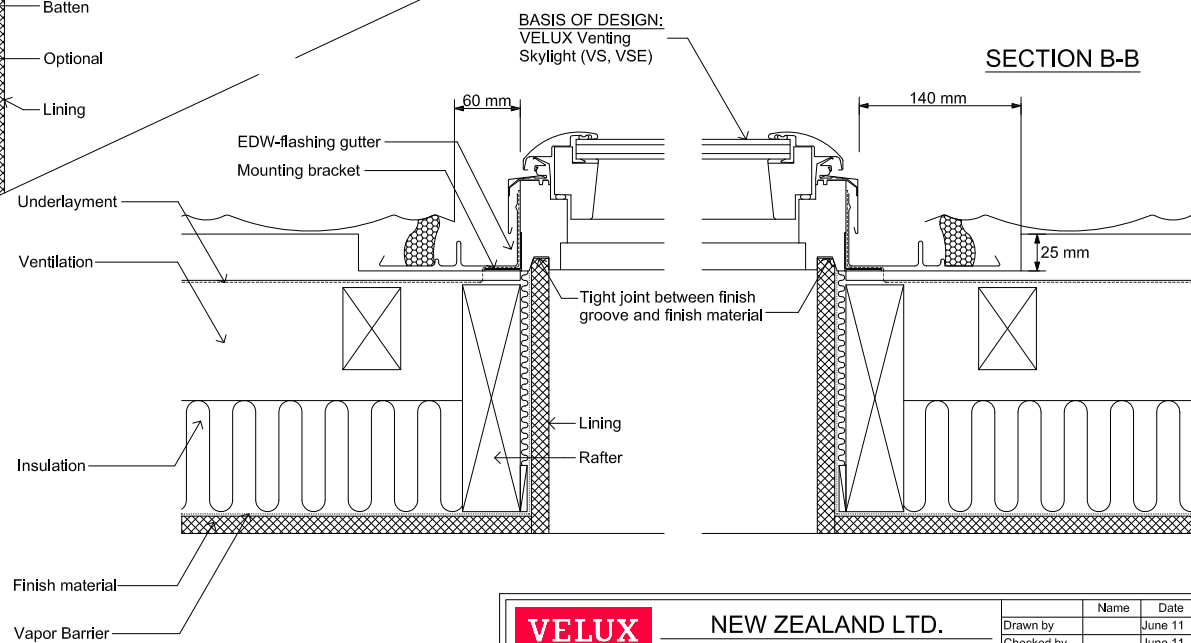

VELUX

NEW ZEALAND LTD.

Sky-Product Management

0800 650 445

VS, VSE - Venting Skylight and EDW Flashing in Decratile Roof

Name	Date
Drawn by	June 11
Checked by	June 11
Drawing No.	